

spanthout : 45 x 145 mm

gordingen : 45 x 145 mm

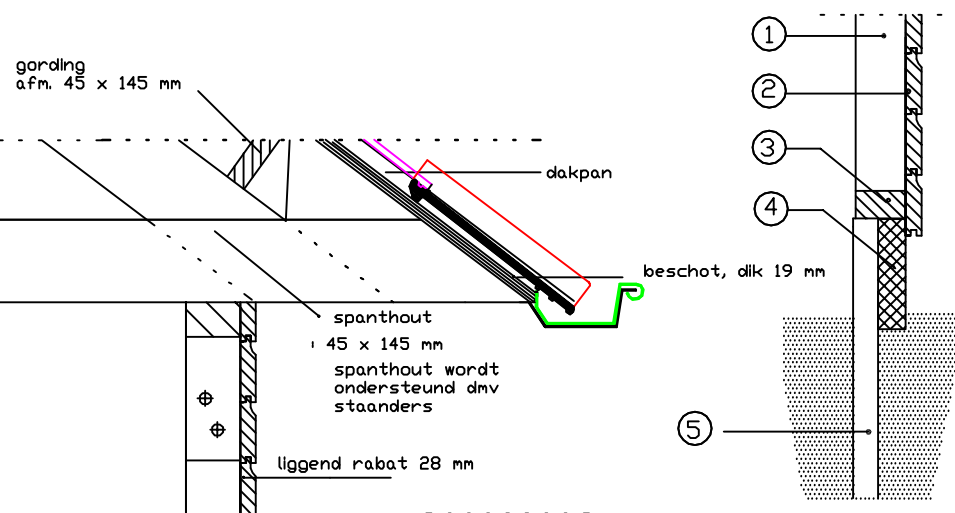
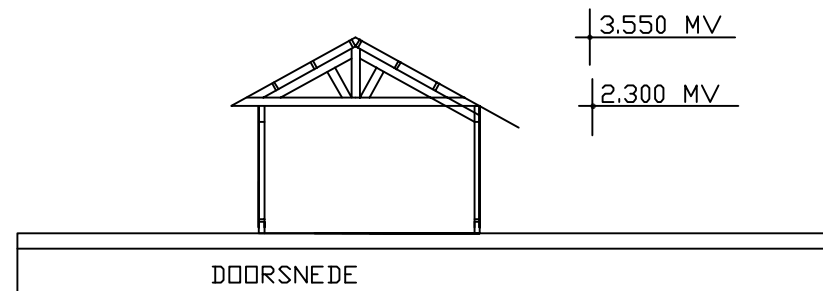
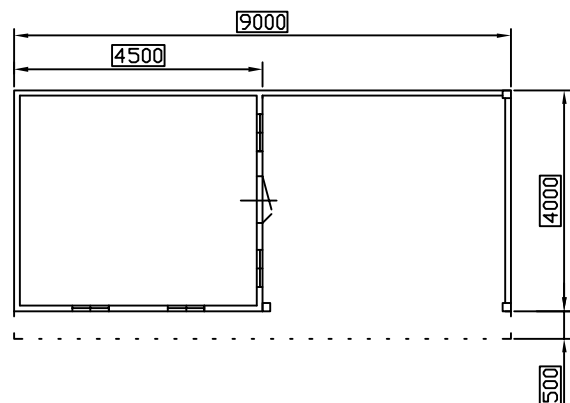

- ① regelwerk 38x89 mm
- ② liggend rabat 28 mm
- ③ regelwerk 38x89 mm
- ④ hardhouten balk 45x145 mm
- ⑤ piketten 45x95 mm hardhout lengte 1250 mm
- ⑥ dakbedekking: dakpan , kleur zwart
- ⑦ dakbeschiëting: dakbeschot 19 mm
- ⑧ deuren: opgeklampt
- ⑨ ramen: meranti 670 X 890

OPDRACHTGEVER: ██████████	KAD. GEM. :
██████████	SECTIE :
██████████	NUMMER :
	SCHAAL :

TYPE :
SCHAAL : 1:100
GET :
patent pending in principal countries of the world

**HOUTBOUW
HIEMSTRA**

